

Kelba Single Point Load Cell (50 - 635kg) KPA 6347

STANDARD CAPACITIES

50 , 75 , 100 , 150 , 200 , 250 , 300 , 500 , 635 kg

SPECIFICATIONS

Rated Output	2.00mV/V ± 10%
Accuracy class	0.03
Non-linearity	0.03 % F.S
Hysteresis	0.03 % F.S
Non-repeatability	0.02 % F.S
Creep in 30 minutes	0.03 % F.S
Temperature effect span	15 PPM / °C of applied Load
Temperature effect zero	26 PPM / °C of applied Load
Compensated temperature range	- 10°C ~ 40 °C
Operating temperature range	- 40°C ~ 65 °C
Zero balance	± 1 % F.S
Input resistance	400 ± 15 Ω
Output resistance	350 ± 3 Ω
Safe overload	150 % F.S
Ultimate overload	300 % F.S
Excitation voltage	10 VAC/DC
Maximum excitation voltage	15 VAC/DC
Insulation resistance	> 5000M Ω (50 V DC)
Environmental protection	IP67
Material	Aluminium
Cable length	6 Mtr

Wiring Color Code

Excitation +	Red	Signal +	Green
Excitation -	Black	Signal -	White

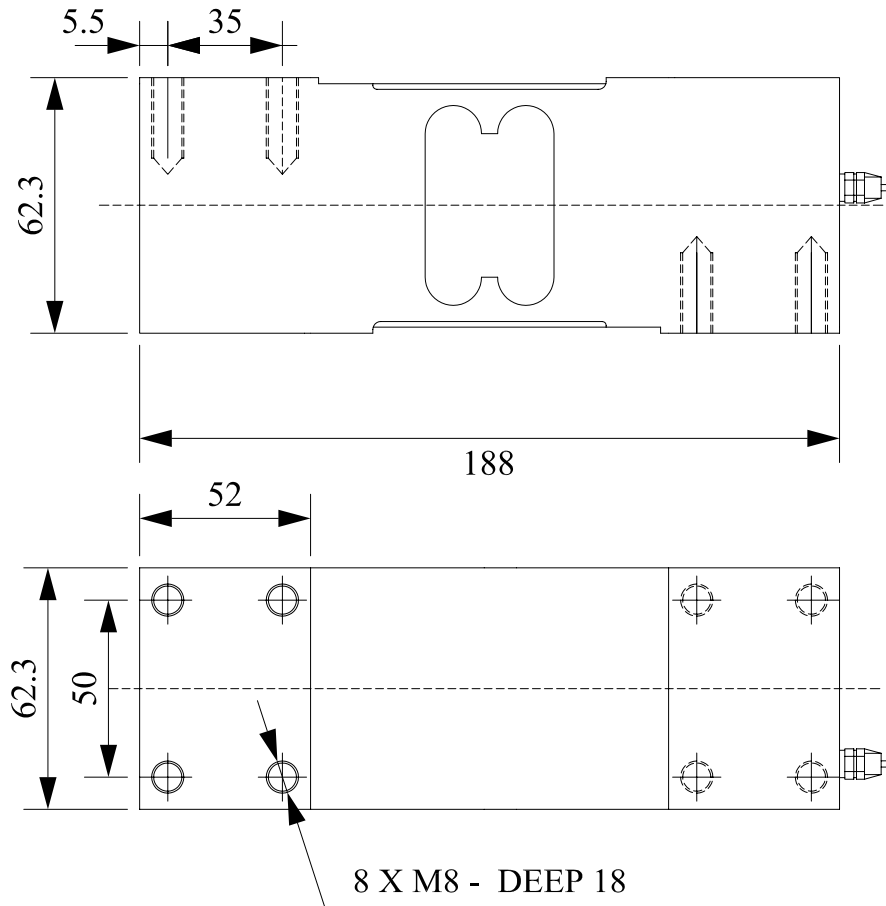

Recommended maximum platform size: 600mm x 600mm

Kelba (Australia) Pty Ltd					
Reference		KPA 6347 Single Point Load Cell 50 - 635 kg			
Date	07/04/03				
Drawn	A TRUCKNER				
Approved		Drg. No.	KPA - 6347 - 1	Rev.	1
Scale	NTS			Date	05/05/04