

Kelba 'S' Type Load Cell KPA 6110P

STANDARD CAPACITIES

100 , 250 , 300 , 500 , 750kg
1 , 1.5 , 2 , 2.5 , 5 , 10 , 20 T

SPECIFICATIONS

| | |
|-------------------------------|-----------------------------|
| Rated Output | 3.00mV/V ± 0.1 |
| Accuracy class | 0.03 |
| Non-linearity | 0.03 % F.S |
| Hysteresis | 0.03 % F.S |
| Non-repeatability | 0.02 % F.S |
| Creep in 30 minutes | 0.03 % F.S |
| Temperature effect span | 15 PPM / °C of applied Load |
| Temperature effect zero | 26 PPM / °C of applied Load |
| Compensated temperature range | - 10°C ~ 40 °C |
| Operating temperature range | - 40°C ~ 65 °C |
| Zero balance | ± 1 % F.S |
| Input resistance | 385 ± 15 Ω |
| Output resistance | 350 ± 3 Ω |
| Safe overload | 150 % F.S |
| Ultimate overload | 300 % F.S |
| Excitation voltage | 10 VAC/DC |
| Maximum excitation voltage | 15 VAC/DC |
| Insulation resistance | > 5000M Ω (50 V DC) |
| Environmental protection | IP67 |
| Material | Alloy tool steel |
| Cable length | 6 Mtr |

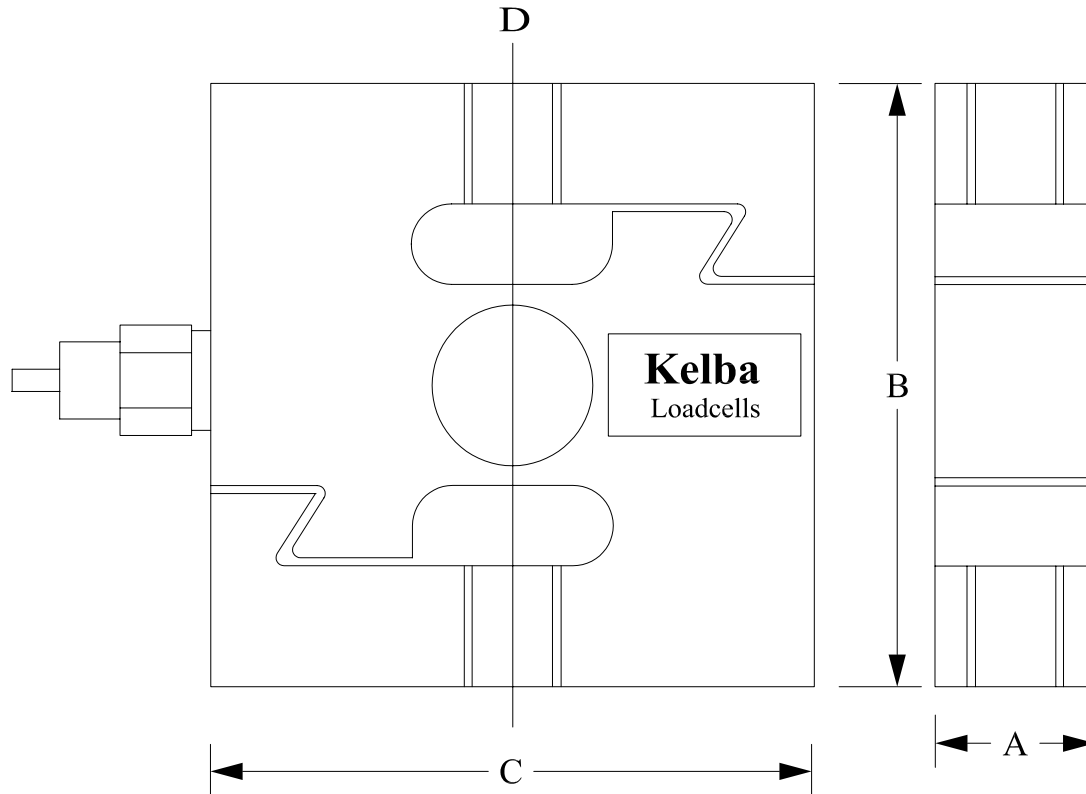

Wiring Color Code

| | |
|--------------------|----------------|
| Excitation + Red | Signal + Green |
| Excitation - Black | Signal - White |

| Capacity | A | B | C | D (THREAD) |
|------------|----|-----|-----|-------------------|
| 100-750 kg | 19 | 80 | 70 | 1/2 - 20 UNF 2B |
| 1-1.5t | 25 | 80 | 70 | 1/2 - 20 UNF 2B |
| 2-5t | 25 | 108 | 95 | 3/4 - 16 UNF 2B |
| 10t | 51 | 178 | 130 | 1 1/4 - 12 UNF 2B |
| 20t | 60 | 190 | 160 | 1 1/2 - 12 UNF 2B |

| Kelba (Australia) Pty Ltd | | | | | |
|---------------------------|-------------|--|------------------|------|----------|
| Reference | | KPA 6110P 'Universal S' Type Load Cell | | | |
| Date | 07/04/03 | | | | |
| Drawn | A. Truckner | | | | |
| Approved | | Drg. No. | KPA - 6110 P - 1 | Rev. | 1 |
| Scale | NTS | | | Date | 05/05/04 |